



HIGH QUALITY
Motor Spindle
MANUFACTURER

BKZ INDUSTRY



Tel

+86 18901426056



Email

sales@bkzindustry.com



Address

No. 7 Chuangye Road,
Daokou Industrial Park,
Jinghe Town, Baoying
County, Yangzhou City,
Jiangsu Province, China

ENTERPRISE INTRODUCTION

BKZ[®]



BKZ Industry is a high-tech company specializing in the R&D, design, production, and sales of high-speed motor spindles and precision spindle solutions.

With decades of manufacturing experience, advanced processing equipment, and strict inspection systems, BKZ Industry provides motor spindles with high precision, high torque, low noise, low vibration, stable speed, and high cutting efficiency.

Our motor spindles have passed ISO9001 and CE certification and are widely used in robotic automation equipment, precision engraving and milling, grinding, high-speed drilling and tapping, high-gloss machining, turn-milling machining centers, and other high-speed CNC fields.

BKZ Industry also supports customized spindle design and production according to different machine tool structures and machining requirements, helping customers obtain suitable spindle solutions for precision and high-speed machining applications.



PRODUCTION AND TESTING

BKZ Industry has advanced production equipment, complete quality inspection systems, mature manufacturing technology, and strict process control. Each motor spindle is manufactured and tested according to strict industry standards to ensure stable performance, reliable quality, high precision, and long service life.



YTD系列永磁同步自动换刀电主轴

YTD Series Permanent Magnet Synchronous Automatic Tool-change Electric Spindle

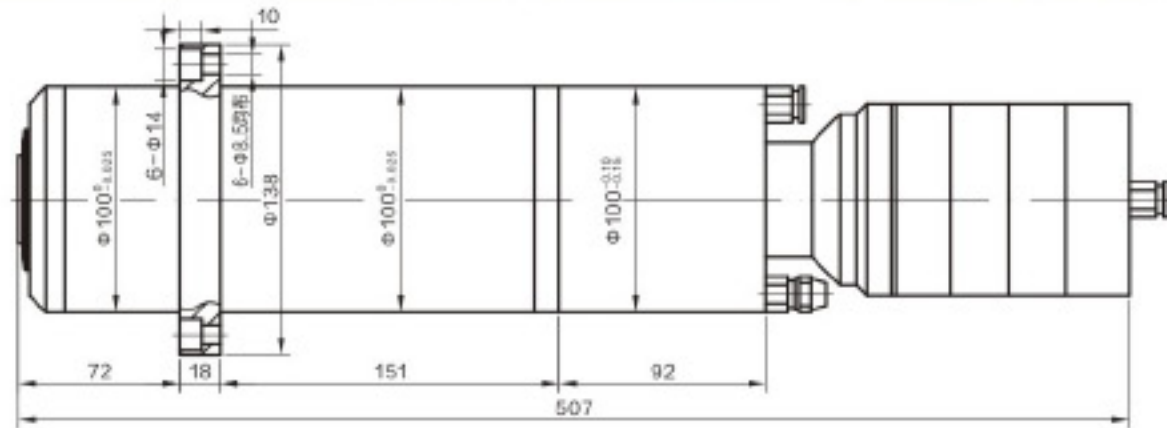

技术参数 Technical Parameters

主轴型号 Spindle Model	YTD100A-8.0	电机极数 Pole Number	4
额定功率 (Kw) Rated Power	8.0	线间电阻 (Ω) Winding Resistance	0.83
额定电流 (A) Rated Current	14.6	线间电感 (mH) Winding Inductance	1.76
堵转电流 (A) Stall Current	16.1	转矩常数 (Nm/A) Torque Constant	0.40
峰值电流 (A) Maximum Current	43.0	反电动势 (V/Krpm) Voltage Constant	24.6
额定电压 (V) Rated Voltage	380	编码器 Encoder	可选 Customer
额定频率 (Hz) Rated Frequency	483	换刀方式 Type Of Tool Change	自动 Automatic
最高频率 (Hz) Maximum Frequency	800	轴端联接 Nose Interface	HSK40/BT30
额定扭矩 (Nm) Rated Torque	5.2	轴承分布 Bearing Distribution	前2后2 Front 2 Rear 2
堵转扭矩 (Nm) Stall Torque	5.8	拉钉规格 Pull Studs Specification	BT30-45°
峰值扭矩 (Nm) Maximum Torque	14.0	润滑方式 Lubrication Form	油脂 Grease
额定转速 (rpm) Rated Speed	14500	冷却方式及介质 Cooling Form and Media	内冷, 水或油 Internal Cooling, Water or Oil
最高转速 (rpm) Maximum Speed	24000	重量 (Kg) Weight	17

YTD系列永磁同步自动换刀电主轴

YTD Series Permanent Magnet Synchronous Automatic Tool-change Electric Spindle

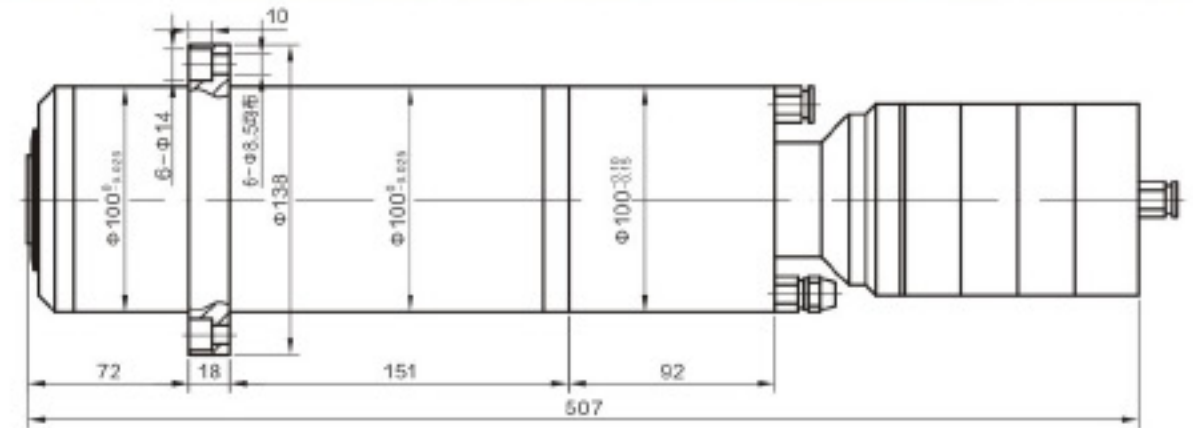

技术参数 Technical Parameters

主轴型号 Spindle Model	YTD100B-12.5	电机极数 Pole Number	4
额定功率 (Kw) Rated Power	12.5	线间电阻 (Ω) Winding Resistance	0.34
额定电流 (A) Rated Current	22.5	线间电感 (mH) Winding Inductance	1.42
堵转电流 (A) Stall Current	27.5	转矩常数 (Nm/A) Torque Constant	0.25
峰值电流 (A) Maximum Current	69.0	反电动势 (V/Krpm) Voltage Constant	15.7
额定电压 (V) Rated Voltage	380	编码器 Encoder	可选 Customer
额定频率 (Hz) Rated Frequency	800	换刀方式 Type Of Tool Change	自动 Automatic
最高频率 (Hz) Maximum Frequency	1133	轴端联接 Nose Interface	HSK40/BT30
额定扭矩 (Nm) Rated Torque	5.0	轴承分布 Bearing Distribution	前2后2 Front 2 Rear 2
堵转扭矩 (Nm) Stall Torque	6.3	拉钉规格 Pull Studs Specification	BT30-45°
峰值扭矩 (Nm) Maximum Torque	14.0	润滑方式 Lubrication Form	油脂 Grease
额定转速 (rpm) Rated Speed	24000	冷却方式及介质 Cooling Form and Media	内冷, 水或油 Internal Cooling, Water or Oil
最高转速 (rpm) Maximum Speed	34000	重量 (Kg) Weight	17

YTD系列永磁同步自动换刀电主轴

YTD Series Permanent Magnet Synchronous Automatic Tool-change Electric Spindle

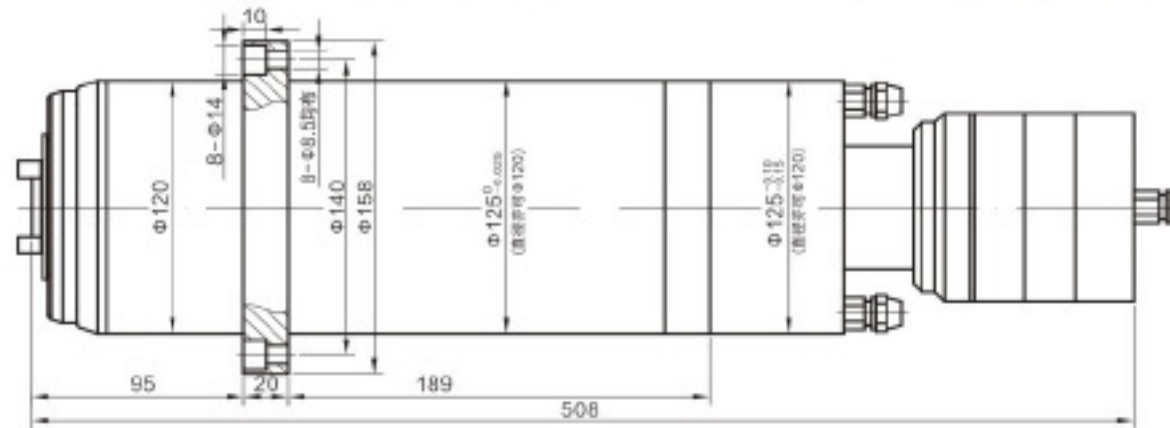

技术参数 Technical Parameters

主轴型号 Spindle Model	YTD125-12.0	电机极数 Pole Number	6
额定功率 (Kw) Rated Power	12.0	线间电阻 (Ω) Winding Resistance	0.5
额定电流 (A) Rated Current	22.0	线间电感 (mH) Winding Inductance	1.8
堵转电流 (A) Stall Current	23.7	转矩常数 (Nm/A) Torque Constant	0.39
峰值电流 (A) Maximum Current	128.0	反电动势 (V/Krpm) Voltage Constant	23.4
额定电压 (V) Rated Voltage	318	编码器 Encoder	可选 Customer
额定频率 (Hz) Rated Frequency	600	换刀方式 Type Of Tool Change	自动 Automatic
最高频率 (Hz) Maximum Frequency	1500	轴端联接 Nose Interface	HSK40/BT30
额定扭矩 (Nm) Rated Torque	9.5	轴承分布 Bearing Distribution	前2后2 Front 2 Rear 2
堵转扭矩 (Nm) Stall Torque	10.2	拉钉规格 Pull Studs Specification	BT30-45°
峰值扭矩 (Nm) Maximum Torque	40.0	润滑方式 Lubrication Form	油脂 Grease
额定转速 (rpm) Rated Speed	12000	冷却方式及介质 Cooling Form and Media	内冷, 水或油 Internal Cooling, Water or Oil
最高转速 (rpm) Maximum Speed	30000	重量 (Kg) Weight	29

YTD系列永磁同步自动换刀电主轴

YTD Series Permanent Magnet Synchronous Automatic Tool-change Electric Spindle

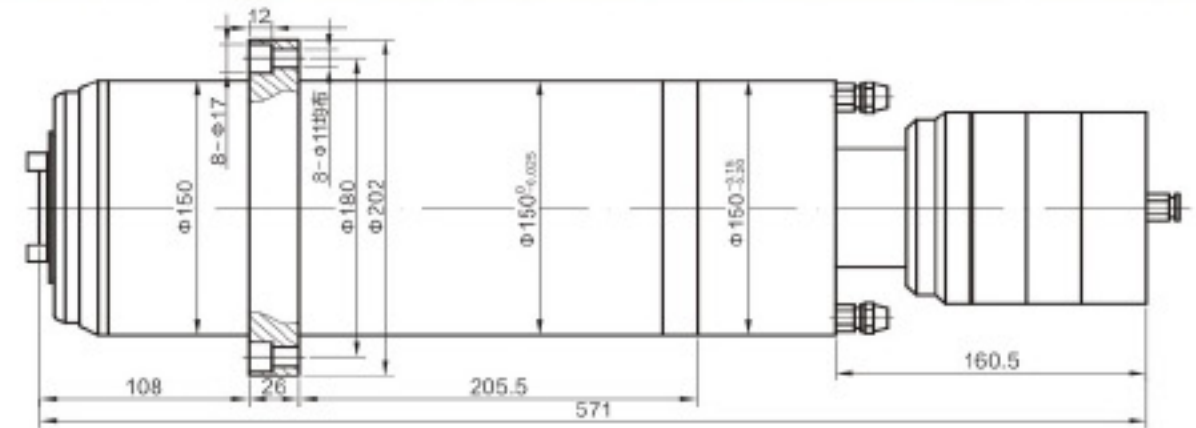

技术参数 Technical Parameters

主轴型号 Spindle Model	YTD150A-20.0	电机极数 Pole Number	6
额定功率 (Kw) Rated Power	20.0	线间电阻 (Ω) Winding Resistance	0.22
额定电流 (A) Rated Current	50.0	线间电感 (mH) Winding Inductance	0.98
堵转电流 (A) Stall Current	51.0	转矩常数 (Nm/A) Torque Constant	0.48
峰值电流 (A) Maximum Current	190.0	反电动势 (V/Krpm) Voltage Constant	28.0
额定电压 (V) Rated Voltage	290	编码器 Encoder	可选 Customer
额定频率 (Hz) Rated Frequency	400	换刀方式 Type Of Tool Change	自动 Automatic
最高频率 (Hz) Maximum Frequency	900	轴端联接 Nose Interface	HSK63A/BT40
额定扭矩 (Nm) Rated Torque	24.0	轴承分布 Bearing Distribution	前2后2 Front 2 Rear 2
堵转扭矩 (Nm) Stall Torque	24.5	拉钉规格 Pull Studs Specification	BT40-45°
峰值扭矩 (Nm) Maximum Torque	76.0	润滑方式 Lubrication Form	油脂 Grease
额定转速 (rpm) Rated Speed	8000	冷却方式及介质 Cooling Form and Media	内冷, 水或油 Internal Cooling, Water or Oil
最高转速 (rpm) Maximum Speed	18000	重量 (Kg) Weight	52

YTD系列永磁同步自动换刀电主轴

YTD Series Permanent Magnet Synchronous Automatic Tool-change Electric Spindle

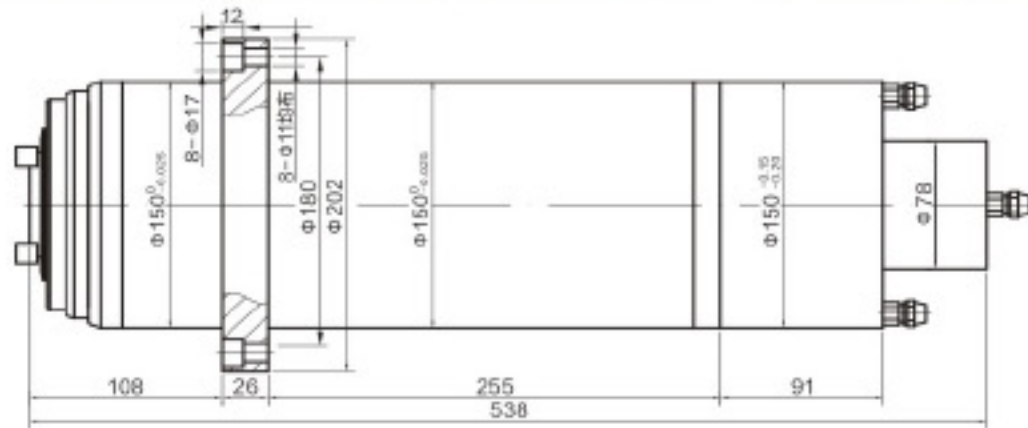

技术参数 Technical Parameters

主轴型号 Spindle Model	YTD150B-29.0	电机极数 Pole Number	6
额定功率 (Kw) Rated Power	29.0	线间电阻 (Ω) Winding Resistance	0.20
额定电流 (A) Rated Current	59.3	线间电感 (mH) Winding Inductance	1.09
堵转电流 (A) Stall Current	62.0	转矩常数 (Nm/A) Torque Constant	0.60
峰值电流 (A) Maximum Current	188.0	反电动势 (V/Krpm) Voltage Constant	33.5
额定电压 (V) Rated Voltage	380	编码器 Encoder	可选 Customer
额定频率 (Hz) Rated Frequency	400	换刀方式 Type Of Tool Change	自动 Automatic
最高频率 (Hz) Maximum Frequency	900	轴端联接 Nose Interface	HSK63A/BT40
额定扭矩 (Nm) Rated Torque	35.0	轴承分布 Bearing Distribution	前2后2 Front 2 Rear 2
堵转扭矩 (Nm) Stall Torque	37.0	拉钉规格 Pull Studs Specification	BT40-45°
峰值扭矩 (Nm) Maximum Torque	99.0	润滑方式 Lubrication Form	油脂 Grease
额定转速 (rpm) Rated Speed	8000	冷却方式及介质 Cooling Form and Media	内冷, 水或油 Internal Cooling, Water or Oil
最高转速 (rpm) Maximum Speed	18000	重量 (Kg) Weight	58

YTD系列永磁同步自动换刀电主轴

YTD Series Permanent Magnet Synchronous Automatic Tool-change Electric Spindle



技术参数 Technical Parameters

主轴型号 Spindle Model	YTD170-36.0	电机极数 Pole Number	6
额定功率 (Kw) Rated Power	36.0	线间电阻 (Ω) Winding Resistance	0.09
额定电流 (A) Rated Current	81.6	线间电感 (mH) Winding Inductance	0.62
堵转电流 (A) Stall Current	86.1	转矩常数 (Nm/A) Torque Constant	0.66
峰值电流 (A) Maximum Current	228.0	反电动势 (V/Krpm) Voltage Constant	36.9
额定电压 (V) Rated Voltage	380	编码器 Encoder	可选 Customer
额定频率 (Hz) Rated Frequency	350	换刀方式 Type Of Tool Change	自动 Automatic
最高频率 (Hz) Maximum Frequency	900	轴端联接 Nose Interface	HSK63A/BT40
额定扭矩 (Nm) Rated Torque	49.3	轴承分布 Bearing Distribution	前2后2 Front 2 Rear 2
堵转扭矩 (Nm) Stall Torque	52.5	拉钉规格 Pull Studs Specification	BT40-45°
峰值扭矩 (Nm) Maximum Torque	124.0	润滑方式 Lubrication Form	油脂 Grease
额定转速 (rpm) Rated Speed	7000	冷却方式及介质 Cooling Form and Media	内冷, 水或油 Internal Cooling, Water or Oil
最高转速 (rpm) Maximum Speed	18000	重量 (Kg) Weight	80

ZHD系列自动换刀电主轴

ZHD Series Automatic Tool-change Electric Spindle



技术参数 Technical Parameters

主轴型号 Spindle Model	ZHD80-2.2	ZHD80-4.0
额定功率 Rated Power(Kw)	2.2	4.0
额定电流 Rated Current(A)	8.9/5.2	15.2/8.8
额定电压 Rated Voltage(V)	220/380	220/380
额定频率 Rated Frequency(Hz)	750	1333
额定扭矩 Rated Torque(Nm)	0.95	0.95
最高频率 Maximum Frequency(Hz)	1333	1333
最高转速 Maximum Speed(rpm)	40000	40000
电机极数 Pole Number	4	4
编码器 Encoder	可选 Customer	可选 Customer
换刀方式 Type Of Tool Change	自动 Automatic	自动 Automatic
轴端联接 Nose Interface	ISO20	ISO20
前轴承内孔尺寸 Inner Bore(mm)	25	25
轴承分布 Bearing Distribution	前2后2 Front 2 Rear 2	前2后2 Front 2 Rear 2
拉钉规格 Pull Studs Specification	ISO20-15°	ISO20-15°
润滑方式 Lubrication Form	油脂 Grease	油脂 Grease
冷却方式及介质 Cooling Form and Media	内冷, 水或油 Internal Cooling, Water or Oil	
重量 Weight(Kg)	9	9

ZHD系列自动换刀电主轴

ZHD Series Automatic Tool-change Electric Spindle



技术参数 Technical Parameters

主轴型号 Spindle Model	ZHD100-3.5	ZHD100-6.0
额定功率 Rated Power(Kw)	3.5	6.0
额定电流 Rated Current(A)	7.8	12.8
额定电压 Rated Voltage(V)	380	380
额定频率 Rated Frequency(Hz)	450	800
额定扭矩 Rated Torque(Nm)	2.4	2.4
最高频率 Maximum Frequency(Hz)	1200	1200
最高转速 Maximum Speed(rpm)	36000	36000
电机极数 Pole Number	4	4
编码器 Encoder	可选 Customer	可选 Customer
换刀方式 Type Of Tool Change	自动 Automatic	自动 Automatic
轴端联接 Nose Interface	ISO25/HSK32E	ISO25/HSK32E
前轴承内孔尺寸 Inner Bore(mm)	25	25
轴承分布 Bearing Distribution	前2后2 Front 2 Rear 2	前2后2 Front 2 Rear 2
拉钉规格 Pull Studs Specification	ISO25-15°	ISO25-15°
润滑方式 Lubrication Form	油脂 Grease	油脂 Grease
冷却方式及介质 Cooling Form and Media	内冷, 水或油 Internal Cooling, Water or Oil	
重量 Weight(Kg)	17	17

ZHD系列自动换刀电主轴

ZHD Series Automatic Tool-change Electric Spindle

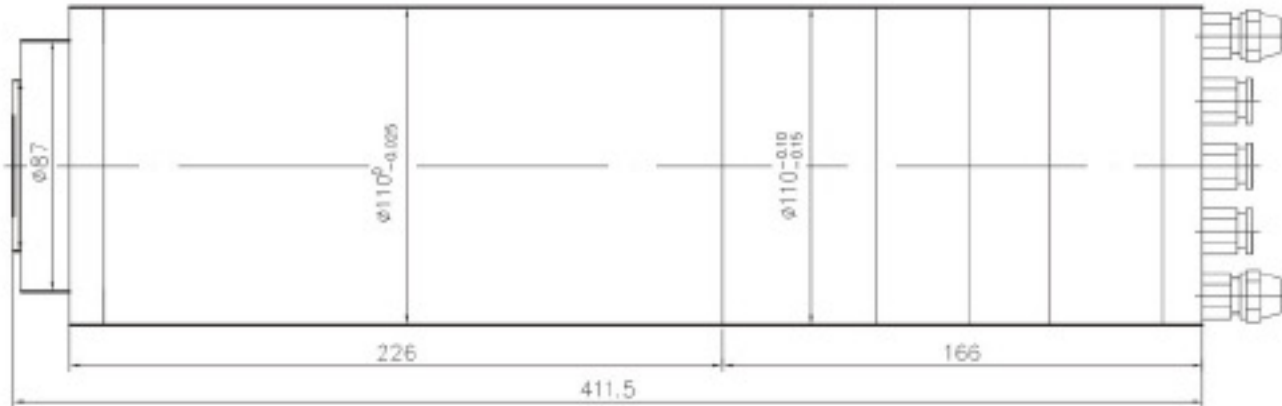

技术参数 Technical Parameters

主轴型号 Spindle Model	ZHD110-3.5	ZHD110-4.5	ZHD110-5.5
额定功率 Rated Power(Kw)	3.5	4.5	5.5
额定电流 Rated Current(A)	7.8	9.8	11.8
额定电压 Rated Voltage(V)	380	380	380
额定频率 Rated Frequency(Hz)	500	600	800
额定扭矩 Rated Torque(Nm)	2.2	2.4	2.2
最高频率 Maximum Frequency(Hz)	1000	1000	1000
最高转速 Maximum Speed(rpm)	30000	30000	30000
电机极数 Pole Number	4	4	4
编码器 Encoder	—	—	—
换刀方式 Type Of Tool Change	自动 Automatic	自动 Automatic	自动 Automatic
轴端联接 Nose Interface	BT30	BT30	BT30
前轴承内孔尺寸 Inner Bore(mm)	35	35	35
轴承分布 Bearing Distribution	前2后2 Front 2 Rear 2	前2后2 Front 2 Rear 2	前2后2 Front 2 Rear 2
拉钉规格 Pull Studs Specification	BT30-45°	BT30-45°	BT30-45°
润滑方式 Lubrication Form	油脂 Grease	油脂 Grease	油脂 Grease
冷却方式及介质 Cooling Form and Media	内冷, 水或油 Internal Cooling, Water or Oil		
重量 Weight(Kg)	18	18	18

ZHD系列自动换刀电主轴

ZHD Series Automatic Tool-change Electric Spindle

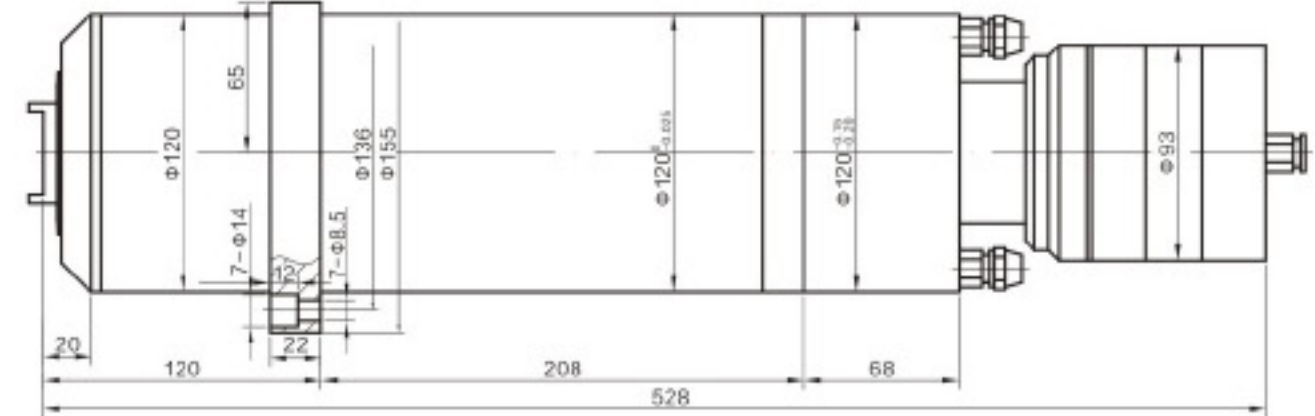

技术参数 Technical Parameters

主轴型号 Spindle Model	ZHD120-7.5	ZHD120-11.0
额定功率 Rated Power(Kw)	7.5	11.0
额定电流 Rated Current(A)	15.6	22.5
额定电压 Rated Voltage(V)	380	380
额定频率 Rated Frequency(Hz)	300	450
额定扭矩 Rated Torque(Nm)	8.0	8.0
最高频率 Maximum Frequency(Hz)	800	800
最高转速 Maximum Speed(rpm)	24000	24000
电机极数 Pole Number	4	4
编码器 Encoder	可选 Customer	可选 Customer
换刀方式 Type Of Tool Change	自动 Automatic	自动 Automatic
轴端联接 Nose Interface	BT30	BT30
前轴承内孔尺寸 Inner Bore(mm)	45	45
轴承分布 Bearing Distribution	前2后2 Front 2 Rear 2	前2后2 Front 2 Rear 2
拉钉规格 Pull Studs Specification	BT30-45°	BT30-45°
润滑方式 Lubrication Form	油脂 Grease	油脂 Grease
冷却方式及介质 Cooling Form and Media	内冷, 水或油 Internal Cooling, Water or Oil	
重量 Weight(Kg)	28	28

ZHD系列自动换刀电主轴

ZHD Series Automatic Tool-change Electric Spindle



技术参数 Technical Parameters

主轴型号 Spindle Model	ZHD125A-4.5	ZHD125A-5.5
额定功率 Rated Power(Kw)	4.5	5.5
额定电流 Rated Current(A)	9.8	11.8
额定电压 Rated Voltage(V)	380	380
额定频率 Rated Frequency(Hz)	400	500
额定扭矩 Rated Torque(Nm)	3.6	3.5
最高频率 Maximum Frequency(Hz)	1000	1000
最高转速 Maximum Speed(rpm)	30000	30000
电机极数 Pole Number	4	4
编码器 Encoder	—	—
换刀方式 Type Of Tool Change	自动 Automatic	自动 Automatic
轴端联接 Nose Interface	BT30	BT30
前轴承内孔尺寸 Inner Bore(mm)	40	40
轴承分布 Bearing Distribution	前2后2 Front 2 Rear 2	前2后2 Front 2 Rear 2
拉钉规格 Pull Studs Specification	BT30-45°	BT30-45°
润滑方式 Lubrication Form	油脂 Grease	油脂 Grease
冷却方式及介质 Cooling Form and Media	内冷, 水或油 Internal Cooling, Water or Oil	
重量 Weight(Kg)	24	24

ZHD系列自动换刀电主轴

ZHD Series Automatic Tool-change Electric Spindle

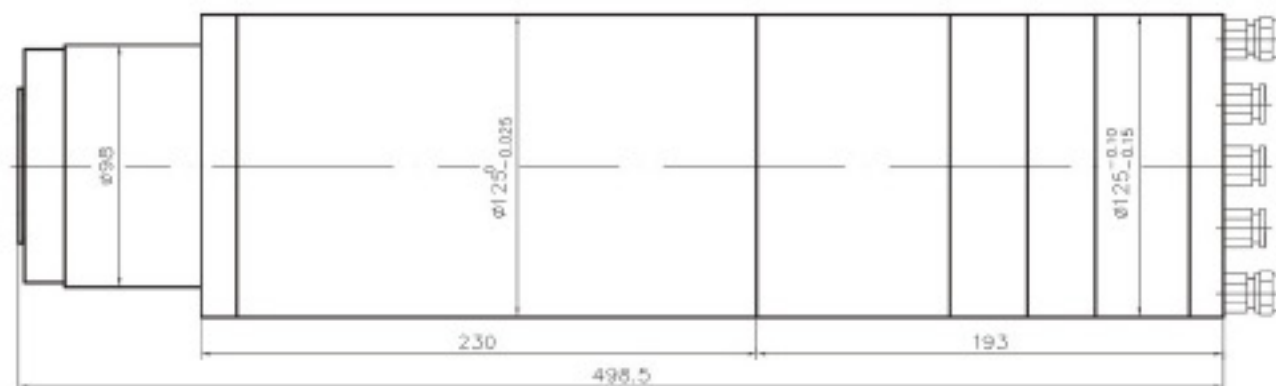

技术参数 Technical Parameters

主轴型号 Spindle Model	ZHD125B-5.5	ZHD125B-7.5
额定功率 Rated Power(Kw)	5.5	7.5
额定电流 Rated Current(A)	11.8	15.6
额定电压 Rated Voltage(V)	380	380
额定频率 Rated Frequency(Hz)	300	400
额定扭矩 Rated Torque(Nm)	6.0	6.0
最高频率 Maximum Frequency(Hz)	800	800
最高转速 Maximum Speed(rpm)	24000	24000
电机极数 Pole Number	4	4
编码器 Encoder	—	—
换刀方式 Type Of Tool Change	自动 Automatic	自动 Automatic
轴端联接 Nose Interface	BT30	BT30
前轴承内孔尺寸 Inner Bore(mm)	40	40
轴承分布 Bearing Distribution	前2后2 Front 2 Rear 2	前2后2 Front 2 Rear 2
拉钉规格 Pull Studs Specification	BT30-45°	BT30-45°
润滑方式 Lubrication Form	油脂 Grease	油脂 Grease
冷却方式及介质 Cooling Form and Media	内冷, 水或油 Internal Cooling, Water or Oil	
重量 Weight(Kg)	28	28

ZHD系列自动换刀电主轴

ZHD Series Automatic Tool-change Electric Spindle

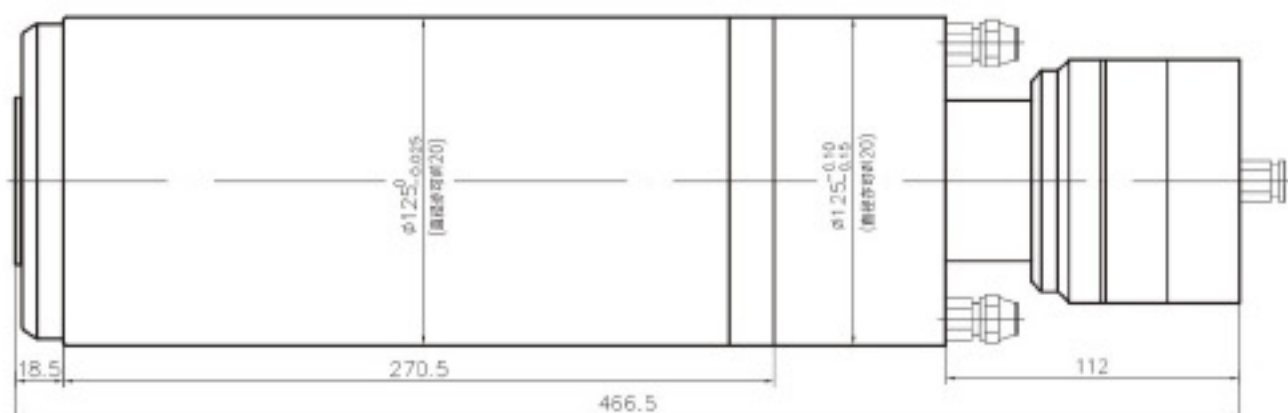

技术参数 Technical Parameters

主轴型号 Spindle Model	ZHD125C-5.5	ZHD125C-7.5
额定功率 Rated Power(Kw)	5.5	7.5
额定电流 Rated Current(A)	11.8	15.6
额定电压 Rated Voltage(V)	380	380
额定频率 Rated Frequency(Hz)	300	400
额定扭矩 Rated Torque(Nm)	6.0	6.0
最高频率 Maximum Frequency(Hz)	1000	1000
最高转速 Maximum Speed(rpm)	30000	30000
电机极数 Pole Number	4	4
编码器 Encoder	可选 Customer	可选 Customer
换刀方式 Type Of Tool Change	自动 Automatic	自动 Automatic
轴端联接 Nose Interface	BT30	BT30
前轴承内孔尺寸 Inner Bore(mm)	40	40
轴承分布 Bearing Distribution	前2后2 Front 2 Rear 2	前2后2 Front 2 Rear 2
拉钉规格 Pull Studs Specification	BT30-45'	BT30-45'
润滑方式 Lubrication Form	油脂 Grease	油脂 Grease
冷却方式及介质 Cooling Form and Media	内冷, 水或油 Internal Cooling, Water or Oil	
重量 Weight(Kg)	28	28

ZHD系列自动换刀电主轴

ZHD Series Automatic Tool-change Electric Spindle

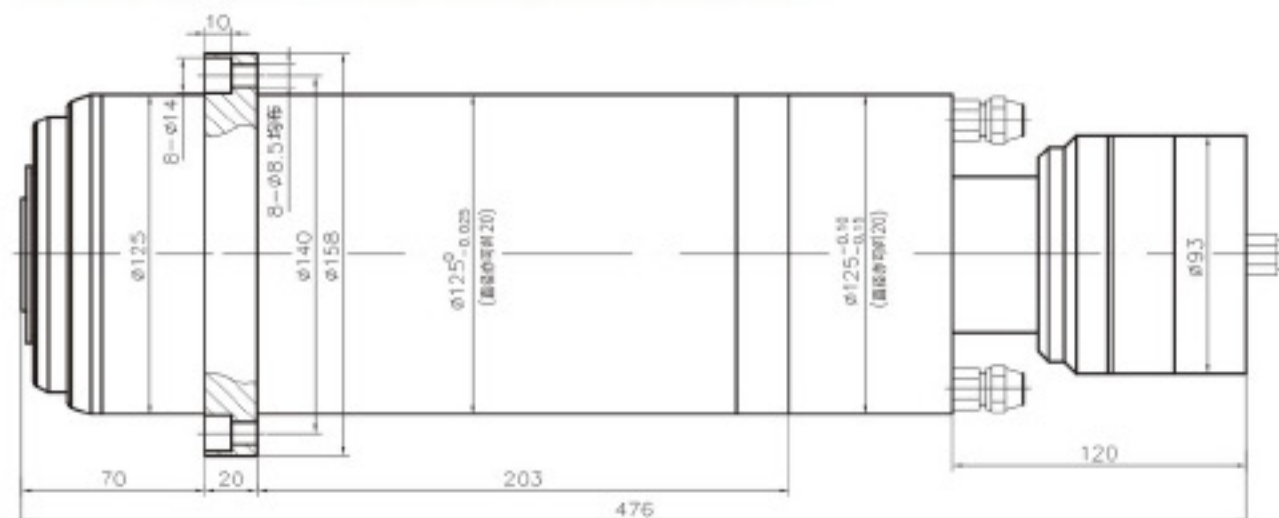

技术参数 Technical Parameters

主轴型号 Spindle Model	ZHD125D-5.5	ZHD125D-7.5
额定功率 Rated Power(Kw)	5.5	7.5
额定电流 Rated Current(A)	11.8	15.6
额定电压 Rated Voltage(V)	380	380
额定频率 Rated Frequency(Hz)	300	400
额定扭矩 Rated Torque(Nm)	6.0	6.0
最高频率 Maximum Frequency(Hz)	1000	1000
最高转速 Maximum Speed(rpm)	30000	30000
电机极数 Pole Number	4	4
编码器 Encoder	可选 Customer	可选 Customer
换刀方式 Type Of Tool Change	自动 Automatic	自动 Automatic
轴端联接 Nose Interface	HSK40	HSK40
前轴承内孔尺寸 Inner Bore(mm)	45	45
轴承分布 Bearing Distribution	前2后2 Front 2 Rear 2	前2后2 Front 2 Rear 2
润滑方式 Lubrication Form	油脂 Grease	油脂 Grease
冷却方式及介质 Cooling Form and Media	内冷, 水或油 Internal Cooling, Water or Oil	
重量 Weight(Kg)	28.5	28.5

ZHD系列自动换刀电主轴

ZHD Series Automatic Tool-change Electric Spindle



技术参数 Technical Parameters

主轴型号 Spindle Model	ZHD125E-5.5	ZHD125E-7.5
额定功率 Rated Power(Kw)	5.5	7.5
额定电流 Rated Current(A)	11.8	15.6
额定电压 Rated Voltage(V)	380	380
额定频率 Rated Frequency(Hz)	350	450
额定扭矩 Rated Torque(Nm)	7.5	8.0
最高频率 Maximum Frequency(Hz)	900	900
最高转速 Maximum Speed(rpm)	18000	18000
电机极数 Pole Number	6	6
编码器 Encoder	可选 Customer	可选 Customer
换刀方式 Type Of Tool Change	自动 Automatic	自动 Automatic
轴端联接 Nose Interface	BT30	BT30
前轴承内孔尺寸 Inner Bore(mm)	45	45
轴承分布 Bearing Distribution	前2后2 Front 2 Rear 2	前2后2 Front 2 Rear 2
拉钉规格 Pull Studs Specification	BT30-45°	BT30-45°
润滑方式 Lubrication Form	油脂 Grease	油脂 Grease
冷却方式及介质 Cooling Form and Media	内冷, 水或油 Internal Cooling, Water or Oil	
重量 Weight(Kg)	30	30

ZHD系列自动换刀电主轴

ZHD Series Automatic Tool-change Electric Spindle

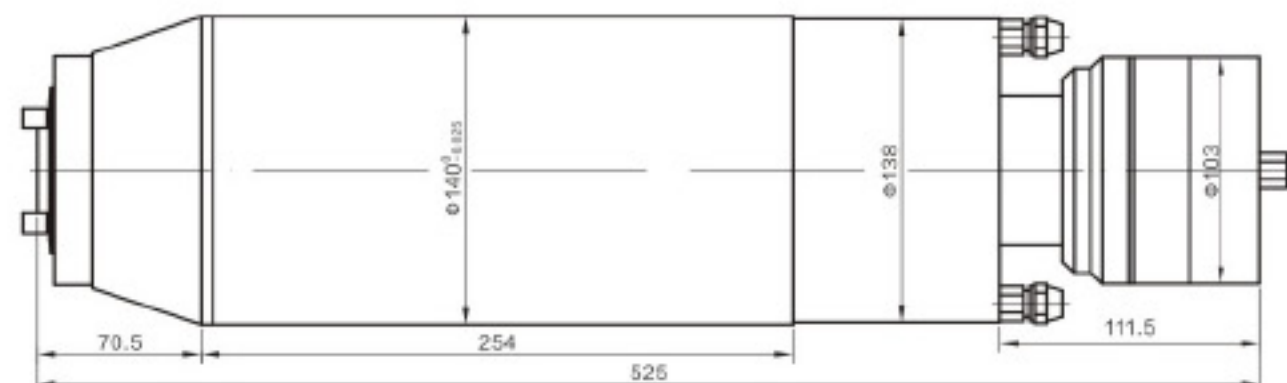

技术参数 Technical Parameters

主轴型号 Spindle Model	ZHD140-5.5	ZHD140-8.0
额定功率 Rated Power(Kw)	5.5	8.0
额定电流 Rated Current(A)	12.8	18.4
额定电压 Rated Voltage(V)	380	380
额定频率 Rated Frequency(Hz)	250	350
额定扭矩 Rated Torque(Nm)	10.5	11.0
最高频率 Maximum Frequency(Hz)	900	900
最高转速 Maximum Speed(rpm)	18000	18000
电机极数 Pole Number	6	6
编码器 Encoder	可选 Customer	可选 Customer
换刀方式 Type Of Tool Change	自动 Automatic	自动 Automatic
轴端联接 Nose Interface	BT30	BT30
前轴承内孔尺寸 Inner Bore(mm)	50	50
轴承分布 Bearing Distribution	前2后2 Front 2 Rear 2	前2后2 Front 2 Rear 2
拉钉规格 Pull Studs Specification	BT30-45°	BT30-45°
润滑方式 Lubrication Form	油脂 Grease	油脂 Grease
冷却方式及介质 Cooling Form and Media	内冷, 水或油 Internal Cooling, Water or Oil	
重量 Weight(Kg)	37	37

ZHD系列自动换刀电主轴

ZHD Series Automatic Tool-change Electric Spindle

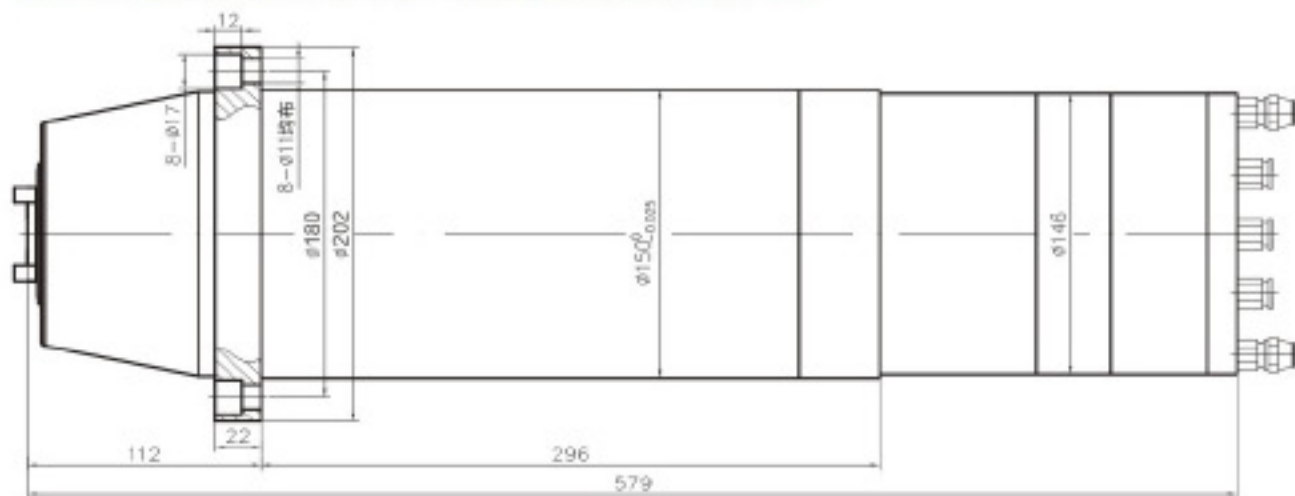

技术参数 Technical Parameters

主轴型号 Spindle Model	ZHD150A-8.0	ZHD150A-11.0
额定功率 Rated Power(Kw)	8.0	11.0
额定电流 Rated Current(A)	17.2	24.5
额定电压 Rated Voltage(V)	380	380
额定频率 Rated Frequency(Hz)	300	350
额定扭矩 Rated Torque(Nm)	12.7	15.0
最高频率 Maximum Frequency(Hz)	900	900
最高转速 Maximum Speed(rpm)	18000	18000
电机极数 Pole Number	6	6
编码器 Encoder	可选 Customer	可选 Customer
换刀方式 Type Of Tool Change	自动 Automatic	自动 Automatic
轴端联接 Nose Interface	BT30	BT30
前轴承内孔尺寸 Inner Bore(mm)	50	50
轴承分布 Bearing Distribution	前2后2 Front 2 Rear 2	前2后2 Front 2 Rear 2
拉钉规格 Pull Studs Specification	BT30-45°	BT30-45°
润滑方式 Lubrication Form	油脂 Grease	油脂 Grease
冷却方式及介质 Cooling Form and Media	内冷, 水或油 Internal Cooling, Water or Oil	内冷, 水或油 Internal Cooling, Water or Oil
重量 Weight(Kg)	48.5	48.5

ZHD系列自动换刀电主轴

ZHD Series Automatic Tool-change Electric Spindle

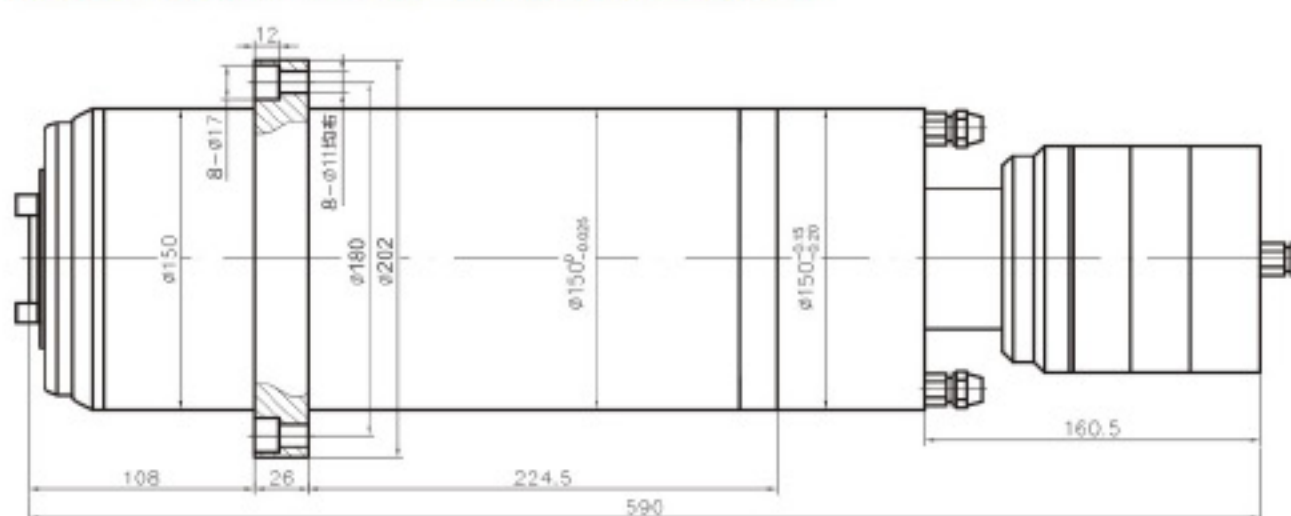

技术参数 Technical Parameters

主轴型号 Spindle Model	ZHD150B-8.0	ZHD150B-11.0
额定功率 Rated Power(Kw)	8.0	11.0
额定电流 Rated Current(A)	17.2	24.5
额定电压 Rated Voltage(V)	380	380
额定频率 Rated Frequency(Hz)	300	350
额定扭矩 Rated Torque(Nm)	12.7	15.0
最高频率 Maximum Frequency(Hz)	900	900
最高转速 Maximum Speed(rpm)	18000	18000
电机极数 Pole Number	6	6
编码器 Encoder	可选 Customer	可选 Customer
换刀方式 Type Of Tool Change	自动 Automatic	自动 Automatic
轴端联接 Nose Interface	BT40/HSK63A	BT40/HSK63A
前轴承内孔尺寸 Inner Bore(mm)	65	65
轴承分布 Bearing Distribution	前2后2 Front 2 Rear 2	前2后2 Front 2 Rear 2
拉钉规格 Pull Studs Specification	BT40-45°	BT40-45°
润滑方式 Lubrication Form	油脂 Grease	油脂 Grease
冷却方式及介质 Cooling Form and Media	内冷, 水或油 Internal Cooling, Water or Oil	内冷, 水或油 Internal Cooling, Water or Oil
重量 Weight(Kg)	52	52

ZHD系列自动换刀电主轴

ZHD Series Automatic Tool-change Electric Spindle

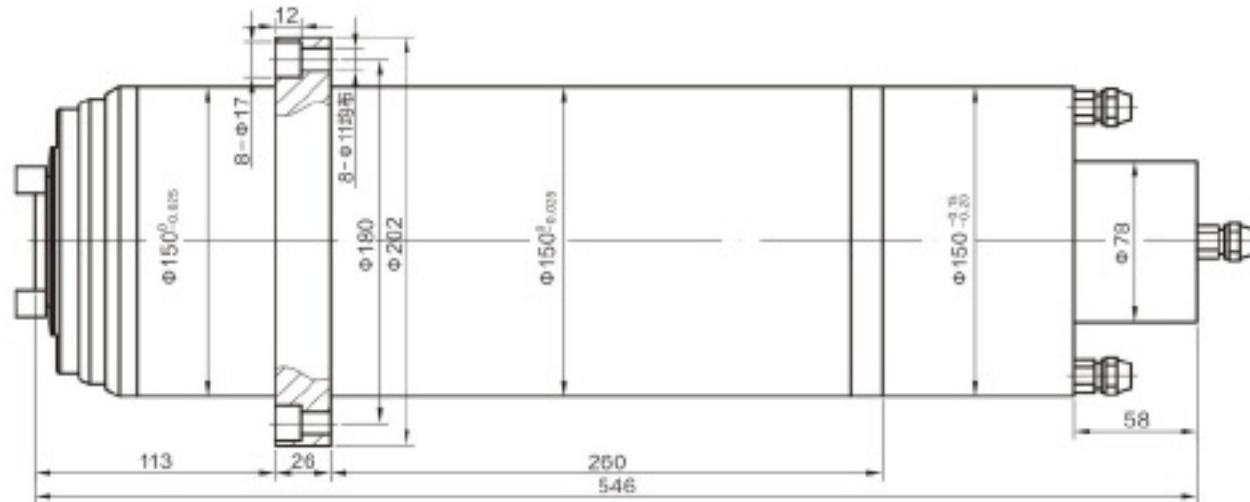

技术参数 Technical Parameters

主轴型号 Spindle Model	ZHD150C-15.0	ZHD150C-18.5
额定功率 Rated Power(Kw)	15.0	18.5
额定电流 Rated Current(A)	31.6	38.6
额定电压 Rated Voltage(V)	380	380
额定频率 Rated Frequency(Hz)	275	350
额定扭矩 Rated Torque(Nm)	26.0	25.2
最高频率 Maximum Frequency(Hz)	900	900
最高转速 Maximum Speed(rpm)	18000	18000
电机极数 Pole Number	6	6
编码器 Encoder	可选 Customer	可选 Customer
换刀方式 Type Of Tool Change	自动 Automatic	自动 Automatic
轴端联接 Nose Interface	BT40/HSK63A	BT40/HSK63A
前轴承内孔尺寸 Inner Bore(mm)	65	65
轴承分布 Bearing Distribution	前2后2 Front 2 Rear 2	前2后2 Front 2 Rear 2
拉钉规格 Pull Studs Specification	BT40-45°	BT40-45°
润滑方式 Lubrication Form	油脂 Grease	油脂 Grease
冷却方式及介质 Cooling Form and Media	内冷, 水或油 Internal Cooling, Water or Oil	
重量 Weight(Kg)	55	55

ZHD系列自动换刀电主轴

ZHD Series Automatic Tool-change Electric Spindle

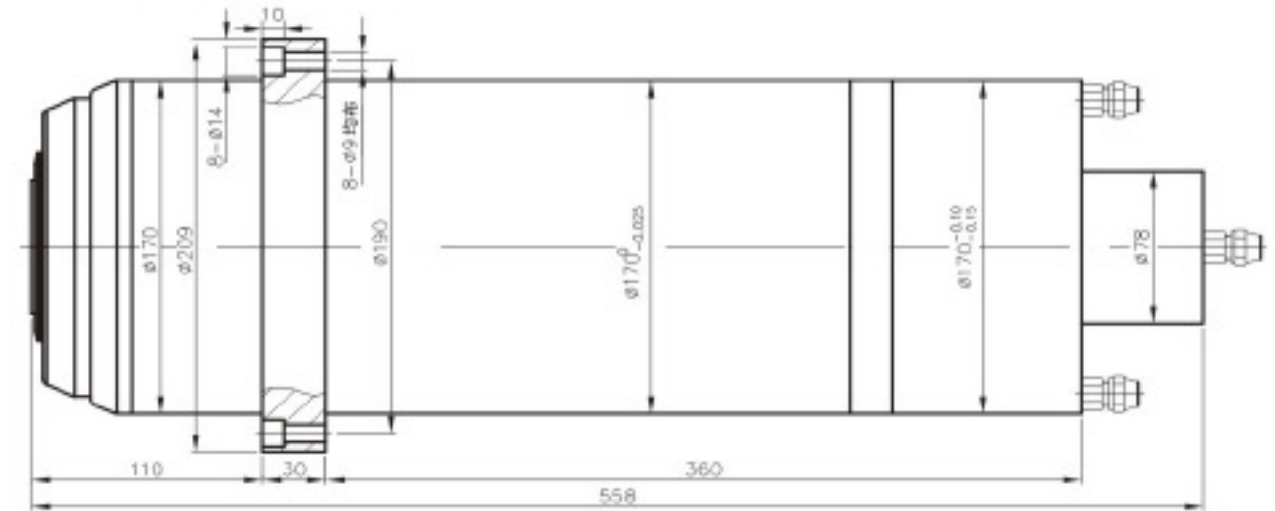

技术参数 Technical Parameters

主轴型号 Spindle Model	ZHD170-18.5	ZHD170-22.0
额定功率 Rated Power(Kw)	18.5	22.0
额定电流 Rated Current(A)	38.6	44.8
额定电压 Rated Voltage(V)	380	380
额定频率 Rated Frequency(Hz)	225	275
额定扭矩 Rated Torque(Nm)	39.3	38.2
最高频率 Maximum Frequency(Hz)	900	900
最高转速 Maximum Speed(rpm)	18000	18000
电机极数 Pole Number	6	6
编码器 Encoder	可选 Customer	可选 Customer
换刀方式 Type Of Tool Change	自动 Automatic	自动 Automatic
轴端联接 Nose Interface	BT40/HSK63A	BT40/HSK63A
前轴承内孔尺寸 Inner Bore(mm)	70	70
轴承分布 Bearing Distribution	前2后2 Front 2 Rear 2	前2后2 Front 2 Rear 2
拉钉规格 Pull Studs Specification	BT40-45°	BT40-45°
润滑方式 Lubrication Form	油气 Oil-Gas	油气 Oil-Gas
冷却方式及介质 Cooling Form and Media	内冷, 水或油 Internal Cooling, Water or Oil	
重量 Weight(Kg)	80	80

ZHD系列自动换刀电主轴

ZHD Series Automatic Tool-change Electric Spindle

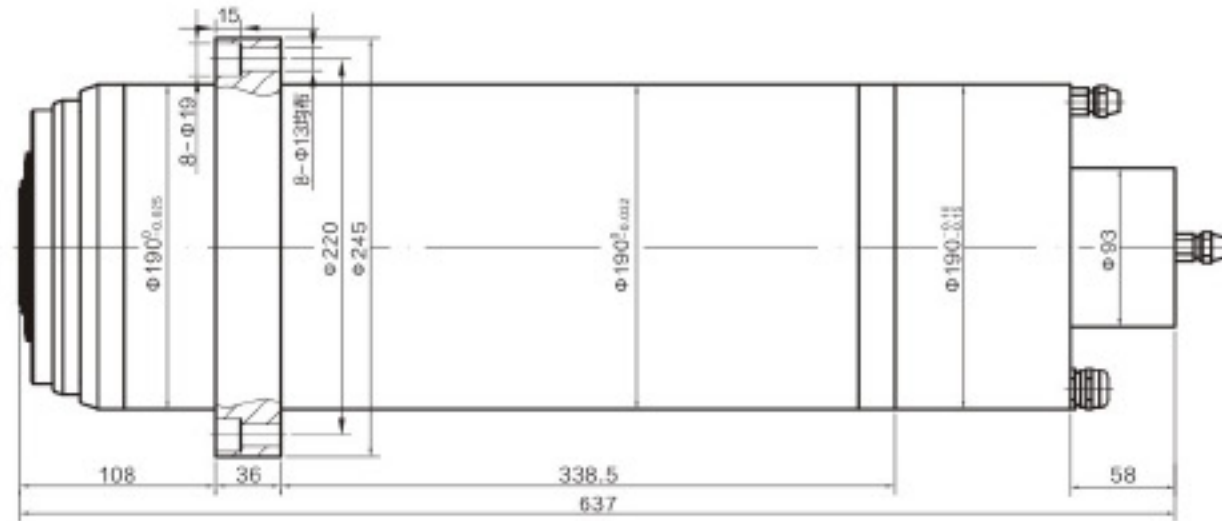

技术参数 Technical Parameters

主轴型号 Spindle Model	ZHD190-28.0	ZHD190-43.0
额定功率 Rated Power(Kw)	28.0	43.0
额定电流 Rated Current(A)	62.5	93.5
额定电压 Rated Voltage(V)	380	380
额定频率 Rated Frequency(Hz)	140	215
额定扭矩 Rated Torque(Nm)	95.5	95.5
最高频率 Maximum Frequency(Hz)	800	800
最高转速 Maximum Speed(rpm)	16000	16000
电机极数 Pole Number	6	6
编码器 Encoder	可选 Customer	可选 Customer
换刀方式 Type Of Tool Change	自动 Automatic	自动 Automatic
轴端联接 Nose Interface	BT40/HSK63A	BT40/HSK63A
前轴承内孔尺寸 Inner Bore(mm)	80	80
轴承分布 Bearing Distribution	前2后2 Front 2 Rear 2	前2后2 Front 2 Rear 2
拉钉规格 Pull Studs Specification	BT40-45°	BT40-45°
润滑方式 Lubrication Form	油脂 Grease	油脂 Grease
冷却方式及介质 Cooling Form and Media	内冷, 水或油 Internal Cooling, Water or Oil	
重量 Weight(Kg)	105	105

ZHD系列自动换刀电主轴

ZHD Series Automatic Tool-change Electric Spindle

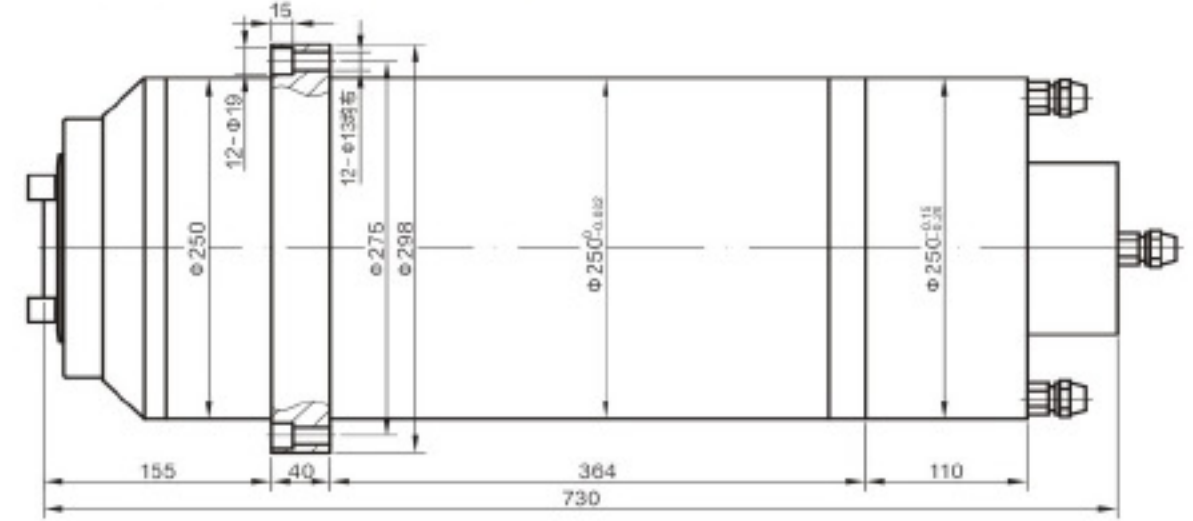

技术参数 Technical Parameters

主轴型号 Spindle Model	ZHD250-22.0	ZHD250-30.0
额定功率 Rated Power(Kw)	22.0	30.0
额定电流 Rated Current(A)	44.8	63.2
额定电压 Rated Voltage(V)	380	380
额定频率 Rated Frequency(Hz)	50	75
额定扭矩 Rated Torque(Nm)	210	191
最高频率 Maximum Frequency(Hz)	300	500
最高转速 Maximum Speed(rpm)	6000	10000
电机极数 Pole Number	6	6
编码器 Encoder	可选 Customer	可选 Customer
换刀方式 Type Of Tool Change	自动 Automatic	自动 Automatic
轴端联接 Nose Interface	BT50/HSK100A	BT50/HSK100A
前轴承内孔尺寸 Inner Bore(mm)	100	100
轴承分布 Bearing Distribution	前2后2 Front 2 Rear 2	前2后2 Front 2 Rear 2
拉钉规格 Pull Studs Specification	BT50-45°	BT50-45°
润滑方式 Lubrication Form	油脂 Grease	油脂 Grease
冷却方式及介质 Cooling Form and Media	内冷, 水或油 Internal Cooling, Water or Oil	
重量 Weight(Kg)	220	220

GWD系列恒功率电主轴

GWD Series Constant Power Electric Spindel

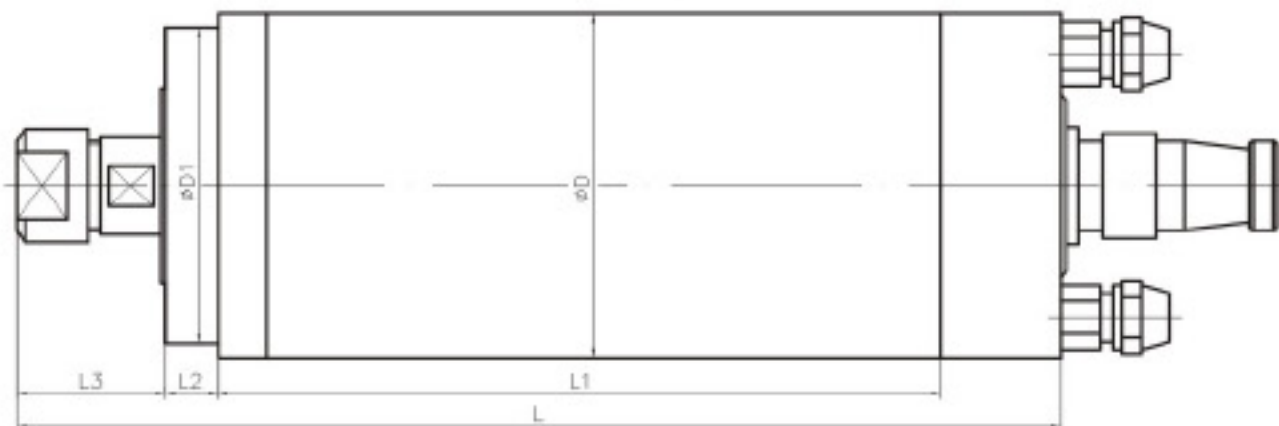

技术参数 Technical Parameters

主轴型号 Spindle Model	GWD48	GWD62	GWD80A	
额定功率 Rated Power(Kw)	0.3	0.8	1.5	
额定电流 Rated Current(A)	3.5	2.9	5.9	
额定电压 Rated Voltage(V)	75	220	220	
额定频率 Rated Frequency(Hz)	400	300	400	
额定扭矩 Rated Torque(Nm)	0.12	0.42	0.6	
最高频率 Maximum Frequency(Hz)	667	500	400	
最高转速 Maximum Speed(rpm)	40000	30000	24000	
电机极数 Pole Number	2	2	2	
换刀方式 Type Of Tool Change	手动 Manual	手动 Manual	手动 Manual	
轴端联接 Nose Interface	ER8	ER11	ER16	
轴承分布 Bearing Distribution	前1后1 Front 1 Rear 1	前2后1 Front 2 Rear 1	前2后1 Front 2 Rear 1	
润滑方式 Lubrication Form	油脂 Grease	油脂 Grease	油脂 Grease	
冷却方式及介质 Cooling Form and Media	内冷, 水或油 Internal Cooling, Water or Oil			
重量 Weight(Kg)	1.5	3.5	7.0/8.0	
尺寸(mm) Dimension	D	48	62	80/85
	D1	42	52	78
	L	152	219	266
	L1	116	160	185
	L2	5	7	13
	L3	24	27	38

GWD系列恒功率电主轴

GWD Series Constant Power Electric Spindel

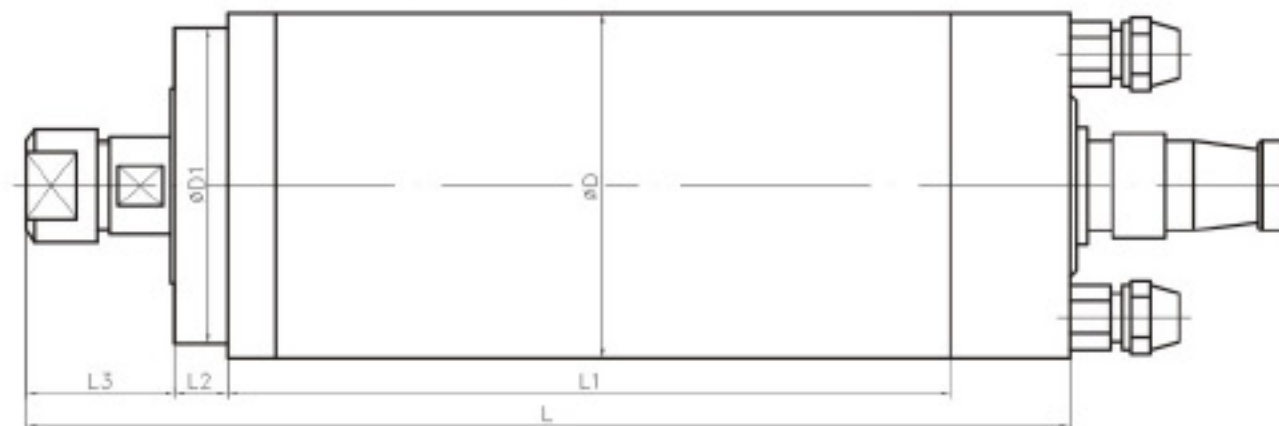

技术参数 Technical Parameters

主轴型号 Spindle Model	GWD80B	GWD85	GWD100	
额定功率 Rated Power(Kw)	2.2	2.2	2.2/3.2	
额定电流 Rated Current(A)	8.9/5.1	8.4/4.8	4.8/6.8	
额定电压 Rated Voltage(V)	220/380	220/380	380	
额定频率 Rated Frequency(Hz)	800	300	250/300	
额定扭矩 Rated Torque(Nm)	0.9	1.2	1.4/1.7	
最高频率 Maximum Frequency(Hz)	800	400	400	
最高转速 Maximum Speed(rpm)	24000	24000	24000	
电机极数 Pole Number	4	2	2	
换刀方式 Type Of Tool Change	手动 Manual	手动 Manual	手动 Manual	
轴端联接 Nose Interface	ER20	ER20	ER20	
轴承分布 Bearing Distribution	前2后2 Front 2 Rear 2	前2后2 Front 2 Rear 2	前2后2 Front 2 Rear 2	
润滑方式 Lubrication Form	油脂 Grease	油脂 Grease	油脂 Grease	
冷却方式及介质 Cooling Form and Media	内冷, 水或油 Internal Cooling, Water or Oil			
重量 Weight(Kg)	8.8	10.8	12.0	
尺寸(mm) Dimension	D	80	85	100
	D1	78	78	73
	L	318	339	299
	L1	238	259	214
	L2	12	12	12
	L3	38	38	38

GWD系列恒功率电主轴

GWD Series Constant Power Electric Spindel

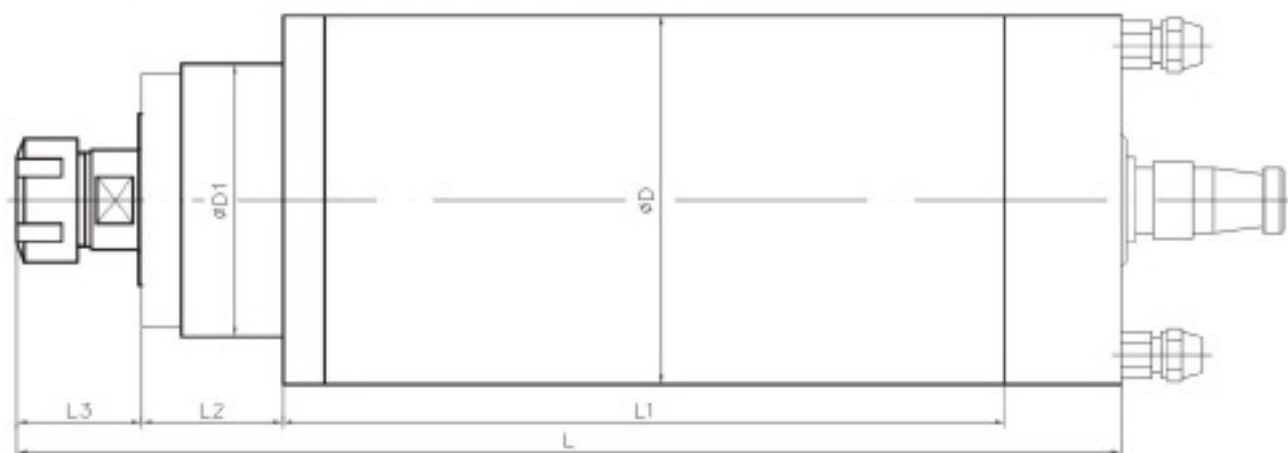

技术参数 Technical Parameters

主轴型号 Spindle Model	GWD105	GWD110	GWD125A	
额定功率 Rated Power(Kw)	3.2	4.0	4.0/5.5	
额定电流 Rated Current(A)	6.8	8.8	8.8/11.8	
额定电压 Rated Voltage(V)	380	380	380	
额定频率 Rated Frequency(Hz)	200	250	200/275	
额定扭矩 Rated Torque(Nm)	2.5	2.5	3.2	
最高频率 Maximum Frequency(Hz)	400	400	400	
最高转速 Maximum Speed(rpm)	24000	24000	24000	
电机极数 Pole Number	2	2	2	
换刀方式 Type Of Tool Change	手动 Manual	手动 Manual	手动 Manual	
轴端联接 Nose Interface	ER20	ER25	ER25	
轴承分布 Bearing Distribution	前2后2 Front 2 Rear 2	前2后2 Front 2 Rear 2	前2后2 Front 2 Rear 2	
润滑方式 Lubrication Form	油脂 Grease	油脂 Grease	油脂 Grease	
冷却方式及介质 Cooling Form and Media	内冷, 水或油 Internal Cooling, Water or Oil			
重量 Weight(Kg)	15.0/16.5	16.5	20.5/22.0	
尺寸(mm) Dimension	D	105/110	110	120/125
	D1	80	86	92.5
	L	333	340	357
	L1	224	224	239
	L2	33	35	35
	L3	40	44	43

GWD系列恒功率电主轴

GWD Series Constant Power Electric Spindel

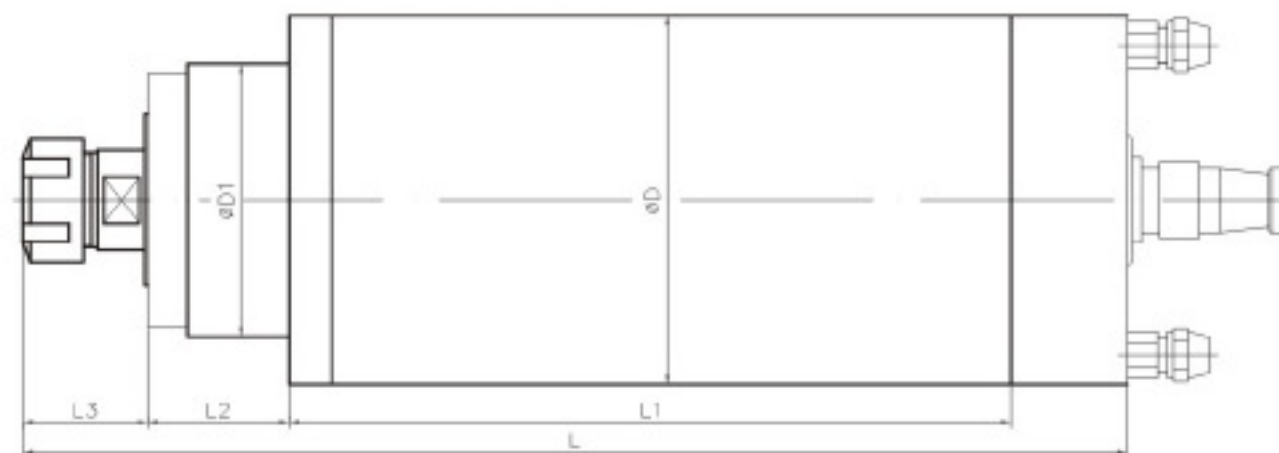

技术参数 Technical Parameters

主轴型号 Spindle Model	GWD125B	GWD125C	GWD125D	
额定功率 Rated Power(Kw)	5.5	5.5	5.5/7.5	
额定电流 Rated Current(A)	11.8	11.8	11.8/15.6	
额定电压 Rated Voltage(V)	380	380	380	
额定频率 Rated Frequency(Hz)	400	400	300/400	
额定扭矩 Rated Torque(Nm)	4.4	4.4	6.0	
最高频率 Maximum Frequency(Hz)	800	800	800	
最高转速 Maximum Speed(rpm)	24000	24000	24000	
电机极数 Pole Number	4	4	4	
换刀方式 Type Of Tool Change	手动 Manual	手动 Manual	手动 Manual	
轴端联接 Nose Interface	ER25	ER32	ER25	
轴承分布 Bearing Distribution	前2后2 Front 2 Rear 2	前2后2 Front 2 Rear 2	前2后2 Front 2 Rear 2	
润滑方式 Lubrication Form	油脂 Grease	油脂 Grease	油脂 Grease	
冷却方式及介质 Cooling Form and Media	内冷, 水或油 Internal Cooling, Water or Oil			
重量 Weight(Kg)	24.0/22.0	24.0/22.0	26.0	
尺寸(mm) Dimension	D	125/120	125/120	125
	D1	92	98	92
	L	390	398	394
	L1	263	268	263
	L2	46	46	46
	L3	40	46	46

GWD系列恒功率电主轴

GWD Series Constant Power Electric Spindel

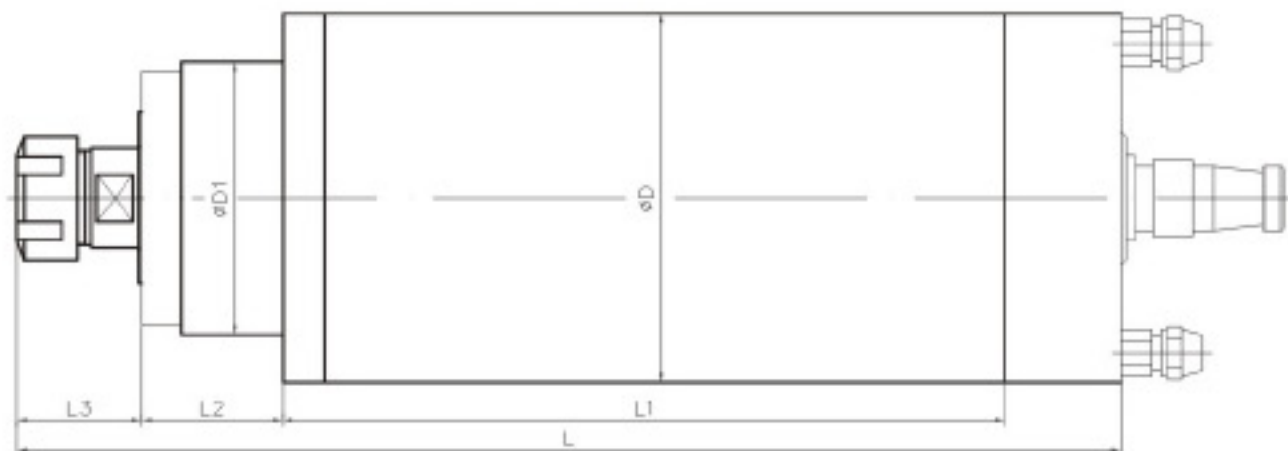

技术参数 Technical Parameters

主轴型号 Spindle Model	GWD125E	GWD125F	GWD140A	
额定功率 Rated Power(Kw)	5.5/7.5	5.5/7.5	5.5/7.5	
额定电流 Rated Current(A)	11.8/15.6	11.8/15.6	11.8/15.6	
额定电压 Rated Voltage(V)	380	380	380	
额定频率 Rated Frequency(Hz)	300/400	350/450	350/450	
额定扭矩 Rated Torque(Nm)	6.0	7.5/8.0	7.5/8.0	
最高频率 Maximum Frequency(Hz)	800	900	900	
最高转速 Maximum Speed(rpm)	24000	18000	18000	
电机极数 Pole Number	4	6	6	
换刀方式 Type Of Tool Change	手动 Manual	手动 Manual	手动 Manual	
轴端联接 Nose Interface	ER32	ER32	ER32	
轴承分布 Bearing Distribution	前2后2 Front 2 Rear 2	前2后2 Front 2 Rear 2	前2后2 Front 2 Rear 2	
润滑方式 Lubrication Form	油脂 Grease	油脂 Grease	油脂 Grease	
冷却方式及介质 Cooling Form and Media	内冷, 水或油 Internal Cooling, Water or Oil			
重量 Weight(Kg)	26.0	27.5	35.0	
尺寸(mm) Dimension	D	125	125	140
	D1	98	99	102
	L	398	439	439
	L1	265	295	295
	L2	46	58	58
	L3	48	48	48

GWD系列恒功率电主轴

GWD Series Constant Power Electric Spindel

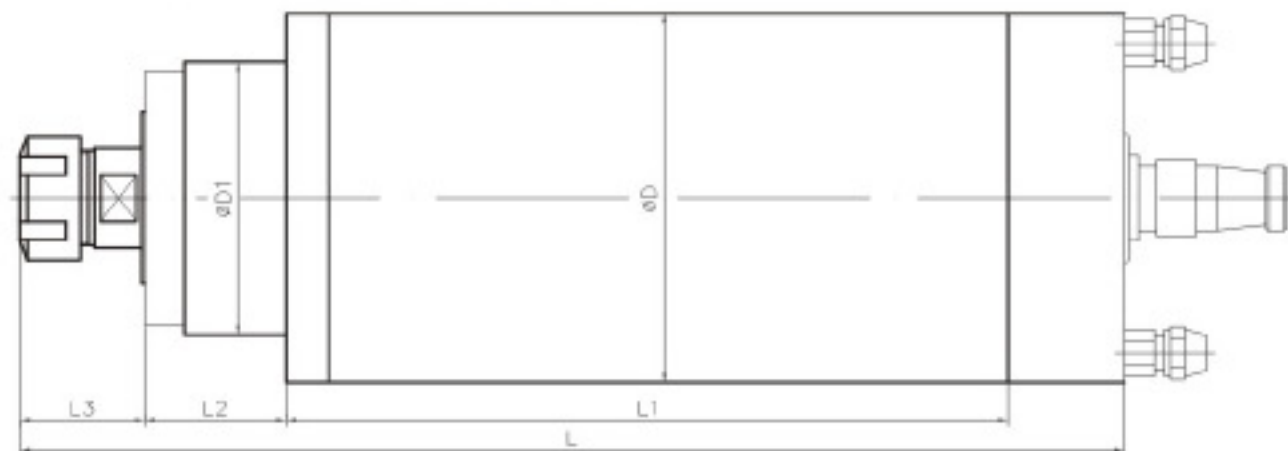

技术参数 Technical Parameters

主轴型号 Spindle Model	GWD140B	GWD140C	GWD140D	
额定功率 Rated Power(Kw)	5.5/7.5	8.0	8.0	
额定电流 Rated Current(A)	11.8/15.6	17.2	17.2	
额定电压 Rated Voltage(V)	380	380	380	
额定频率 Rated Frequency(Hz)	350/450	300	300	
额定扭矩 Rated Torque(Nm)	7.5/8.0	12.7	12.7	
最高频率 Maximum Frequency(Hz)	900	900	900	
最高转速 Maximum Speed(rpm)	18000	18000	18000	
电机极数 Pole Number	6	6	6	
换刀方式 Type Of Tool Change	手动 Manual	手动 Manual	手动 Manual	
轴端联接 Nose Interface	ER32	ER32	ER40	
轴承分布 Bearing Distribution	前2后2 Front 2 Rear 2	前2后2 Front 2 Rear 2	前2后2 Front 2 Rear 2	
润滑方式 Lubrication Form	油脂 Grease	油脂 Grease	油脂 Grease	
冷却方式及介质 Cooling Form and Media	内冷, 水或油 Internal Cooling, Water or Oil			
重量 Weight(Kg)	37.0	34.0	35.5	
尺寸(mm) Dimension	D	140	140/150	140/150
	D1	111	103	111
	L	449	440	447
	L1	298	296	297
	L2	62	58	62
	L3	50	48	50